

Rokka
play™

Instruction Booklet

The Rokka Kitchen Accessory Pack



Contents

Introduction	01
Product Information	02
Warnings - Installation & Usage	03
Warnings - Cleaning Care & Maintenance	04
Parts	06
Assembling the Rokka Kitchen Accessory Pack	08



Introduction

Welcome to the Rokka Kitchen Accessory Pack! We hope your children have hours of enjoyment from this addition to their Rokka. After your children have created picnics and feasts galore you can remove the kitchen accessories, turn the Rokka over into a picnic table and let them enjoy their creations! Our children often run a café for us, providing us with light refreshment and lots of culinary mess... Bon Appétit!

Please read the following information carefully before assembling your Rokka Kitchen Accessory Pack and keep this guide for future reference. If any components are missing or damaged please contact Rokka Play Ltd for a replacement before allowing your child to play on the Rokka.

This user guide is for the Rokka Kitchen Accessory Pack, product number RP/ROK01/003.

Please supervise your children at all times when they are playing with the Rokka and Kitchen Accessory Pack.

Product Information

The Rokka Kitchen Accessory Pack is made from quality birch plywood. The fabric accessories are made from 100% cotton, using azo free dyes. The Rokka and its accessories have been independently tested and comply with EN 71 regulations (Safety of Toys).

Rokka Play Ltd regularly checks the materials and workmanship it employs to produce its products.

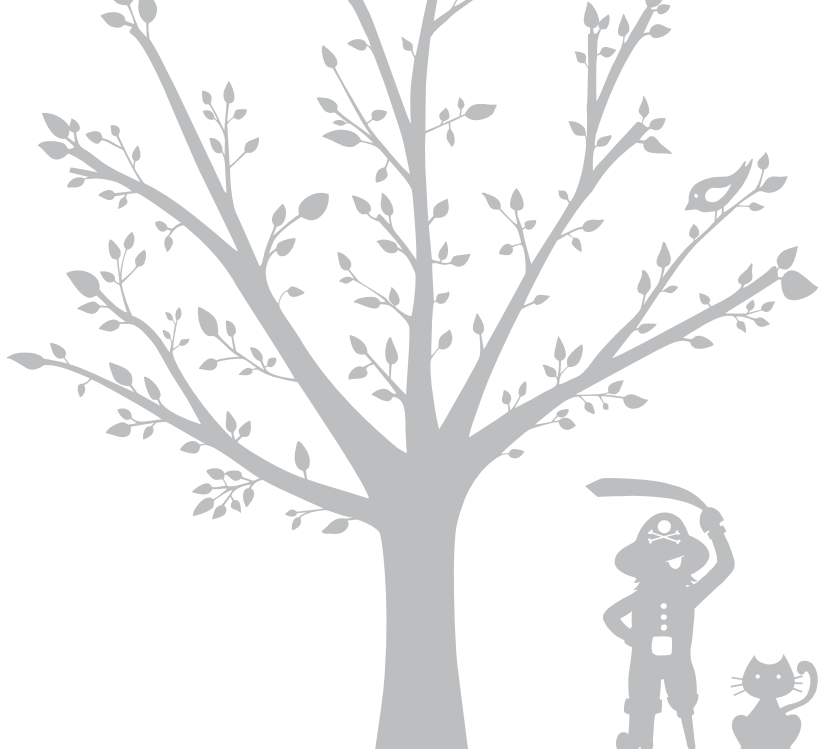

Warnings – Installation & Usage

- Adult assembly required on the tap.
- The Rokka Kitchen Accessory Pack is intended for children aged 1 year and above.
- Do not allow children to stand or climb on the kitchen when assembled, to prevent falling or tipping.
- To prevent injury to your child or damage to the Rokka Kitchen Accessory Pack, do not allow children to swing on or pull on the spoons, either when attached to the Rokka or when being used freely.
- Ensure that the Rokka Kitchen Accessory Pack is used on a level stable surface, to prevent tipping.
- Do not place the Rokka near an open fire or other sources of strong heat, such as electric bar fires, gas fires etc due to the risk of fire.
- Keep plastic bags and other packing materials that may pose a suffocation hazard away from children and safely discard as soon as possible.



Warnings – Cleaning, Care & Maintenance

- Do not use the Rokka if any part or component appears to be broken, damaged or missing.
 - Wipe with clean damp cloth, wiping off excess water. Do not use abrasive or harsh cleaning products, we recommend you use warm soapy water. Do not allow items which may cause staining to sit on the surface of the Rokka.
 - Due to the natural materials used, colour variations will occur in the wood, however if left for prolonged periods in sunlight the overall colour may darken.
 - Fabrics should be hand washed or spot cleaned with a damp cloth. As the fabrics are made from 100% cotton, repeated washing may cause the fabric to stretch slightly.
 - Prolonged exposure in sunlight may cause fading of the fabric colours.
 - The materials have been chosen for their quality and aesthetic, they should grow older gracefully! With regular care your Rokka should last generations.
- DO NOT LEAVE THE ROKKA OUTSIDE IN THE RAIN OR IN DAMP CONDITIONS AS THIS MAY DAMAGE THE PROPERTIES OF THE MATERIALS



Kitchen pack parts – Please check that you have all of the following components in the box

A)

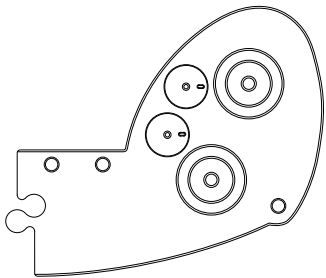

B)

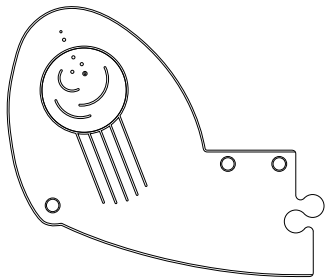

C)

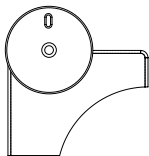

D)

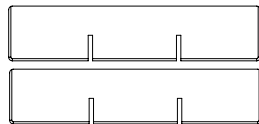

E)

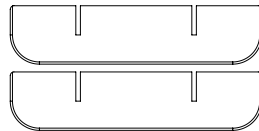

A) Hot Plate (includes 2 x knobs already attached)

B) Sink

C) Tap (includes 2 x knobs already attached)

D) Shelves (square edge) x 2

F)

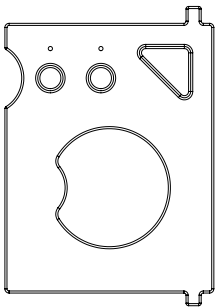

G)

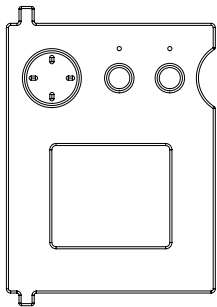

H)

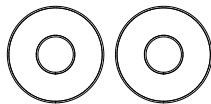

I)



J)

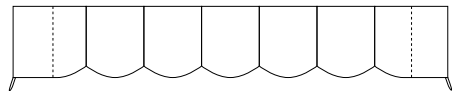

Please note that all hot and cold knobs and wooden dowels should arrive ready fastened. If this is not the case, please contact us.

(Illustrations not to scale)

E) Shelves (round edge) x 2

F) Washing machine door

G) Oven door

H) Washers x 2

I) Screw x 1

J) Pelmet

Assembling the Rokka Kitchen Accessory Pack

Step 1 Attaching the tap

Position the dowel on the Tap **(C)** into the corresponding hole located on the Sink plate **(B)**. Fasten in place using Screw **(I)** provided.

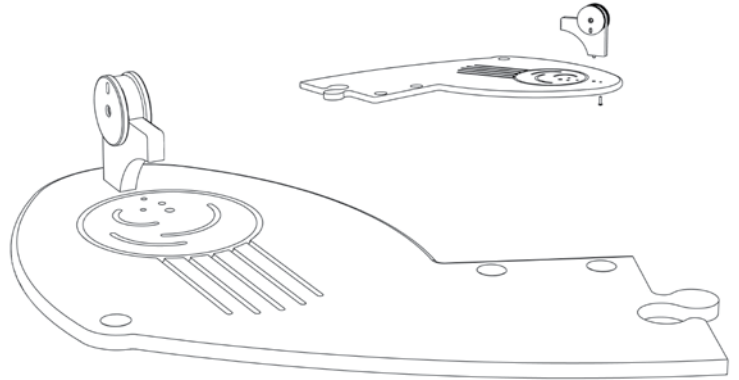

Step 2 Inserting the shelves

With the Rokka on its side, slide the two square edged shelves **(D)** into the grooves above and below on the inside of the Rokka.

Slide the round edged shelves **(E)** into the slots on shelves **(D)**. Both sets of shelves should slide in easily.

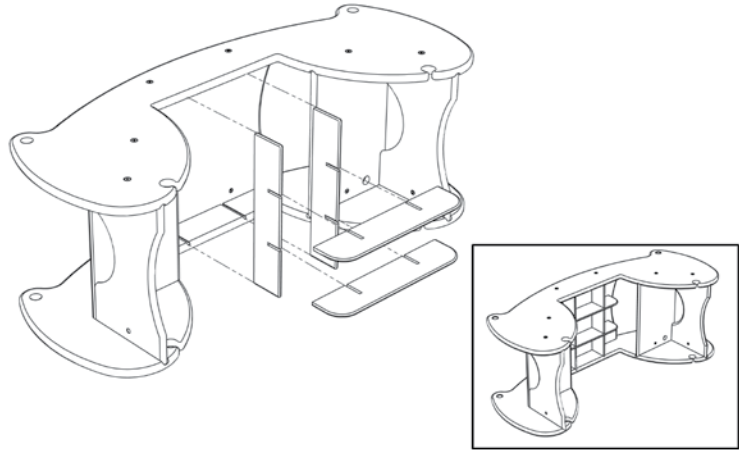

Step 3 Adding the doors

Slide one of the washers **(H)** onto the bottom hinge of the oven door. Holding this washer in place, insert the upper hinge of the door up into the locating hole in the Rokka at a right angle. Then slide the bottom hinge with washer into the lower locating hole and close the door. Repeat this step with the other washer and washing machine door **(G)** on the other side of the Rokka.

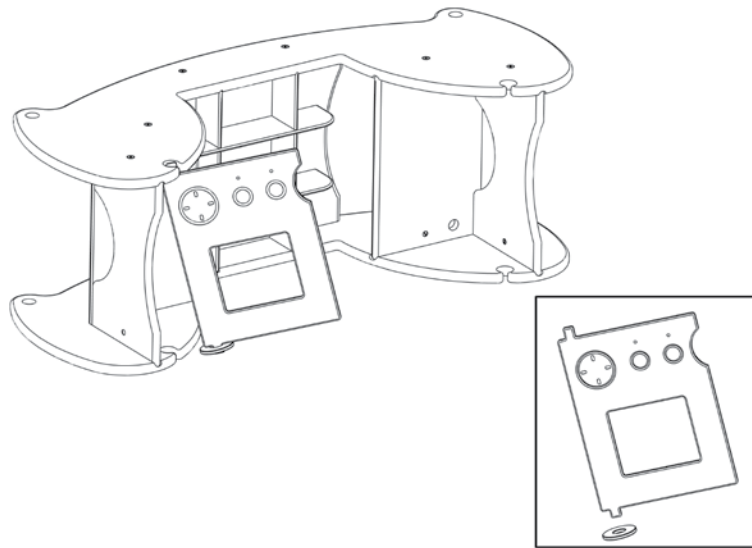

Step 4 Adding the Hotplate and Sink

Place the Hotplate **(A)** and Sink **(B)** onto the Rokka, joining together the jigsaw joins. Thread two of your large spoons, which originally came with the Rokka, into the holes to locate the Hotplate and Sink.

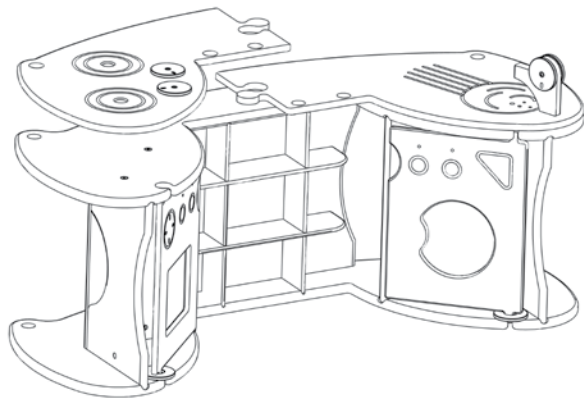

Step 5 Making the window

Slide the pelmet onto the spoon heads to make the window.

And that's how simple it is! There are a few extra holes in the design for using as utensil and tea towel holders, to hang fruit from or whatever else springs to mind.

Do let us know how your children use their kitchen and what their favourite dish is! Check out the website for fun activity ideas and additional play packs at www.rokkaplay.com



The Rokka, an adventure every day

New packs are constantly
in development. Full details
are provided on the website
www.rokkaplay.com or you can
ask your supplier for details.



Kitchen Accessory Pack

The Rokka
Table & Chairs



Theatre Accessory Pack



The Rokka &
Cornish Fishing Boat
Accessory Pack



Registered Address:

Bishop Fleming
Chy Nyverow
Newham Road
Truro
TR1 2DP
UK

www.rokkaplay.com
info@rokkaplay.com



©Rokka Play Ltd.

Rokka is a registered design,
No. 001708173-0001