

02/21



SHOWER STRETCHER DRIP TRAY

INSTRUCTIONS FOR USE
Codes: Ecst001- Ecst006



CONTENTS

<u>1.0 INTRODUCTION</u>	1
<u>2.0 TECHNICAL DATA</u>	2
<u>3.0 INSTALLATION PROCEDURE</u>	2
<u>4.0 USING THE DRIP TRAY</u>	8
<u>5.0 ADJUSTMENTS</u>	10
<u>6.0 FOR YOUR SAFETY</u>	12
<u>7.0 CARE AND MAINTENANCE</u>	13
<u>8.0 DAILY CHECKS</u>	13
<u>9.0 SERVICE</u>	13
<u>10.0 WARRANTY</u>	16
<u>11.0 CONTINUOUS IMPROVEMENT</u>	16
<u>12.0 SERVICE INSPECTION</u>	17

1.0 INTRODUCTION

Thank you for choosing the Drip Tray. The Drip Tray has been designed to fit under several of Smirthwaite's shower stretchers to collect the water during showering and direct it into a drain. By following the instructions in this booklet, installing and using the Drip Tray should be straight forward. However, we're here to help if necessary.

	IMPORTANT!
	<p>These instructions should be read by all therapists and carers using the equipment and should be retained for future reference. The product should always be used under adult supervision.</p> <p>Any incorrect use of the product and failure to follow the instructions may put the user at risk or impede the function. If you have any queries using this product or wish for further copies, please do not hesitate to contact Customer Service department on +44 (0) 1626 835552</p>

2.0 TECHNICAL DATA

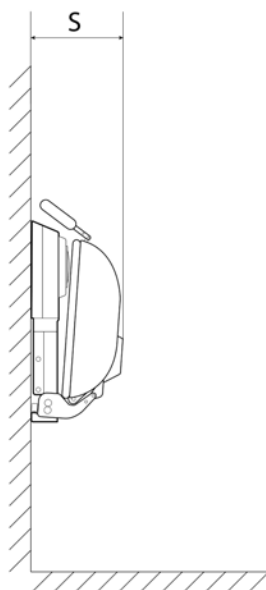

Shower Stretcher	S - Stored width with drip tray (mm)
Easi-Lift Shower Stretcher*	380
Shower Stretcher Adjustable Height*	380
Shower Stretcher Fixed Height*	340

*Please refer to the relevant IFU for full technical data for each specific shower stretcher.

3.0 INSTALLATION PROCEDURE

- Carefully unpack the shower stretcher and lay all parts on to the floor.
- Check all component packs are present.
- Check all components for damage that may have occurred during transit.

3.1 TOOLS REQUIRED

- A set of Hex Keys
- A set of spanners

NOTE: Help from a second person is highly recommended.

3.2 LIST OF PARTS

Drip Tray Frame

Quantity - 1



Drip Tray Frame Extension

Quantity - 2

Drip Tray

Quantity - 1

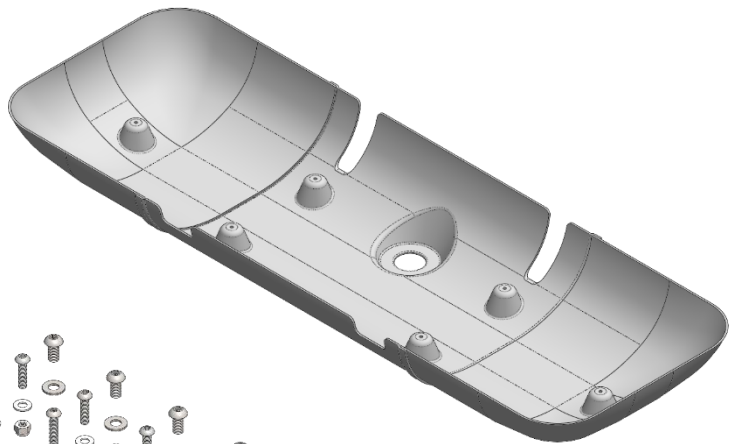

Assembly Component Kit

Quantity - 1

Hose

Quantity - 1

3.3 INSTALLATION INSTRUCTIONS

A shower stretcher should already be installed (see relevant IFU for instructions) before attaching the drip tray. The installation procedure for the drip tray is similar for all Smirthwaite shower stretcher products. For the purpose of this IFU, a Manual Adjustable Shower Stretcher has been used.

Ensure the shower stretcher is in the stowed position before starting the installation procedure (see relevant IFU for instructions).

- Loosen the 4 bolts (highlighted in Fig.1) at the back of the drip tray frame.

- Offer the drip tray frame up to the shower stretcher and secure in place using the M10x20 bolts and washers (highlighted in Fig.2). Ensure that the profiles of the drip tray frame and the arms on the shower stretcher back frame are aligned.

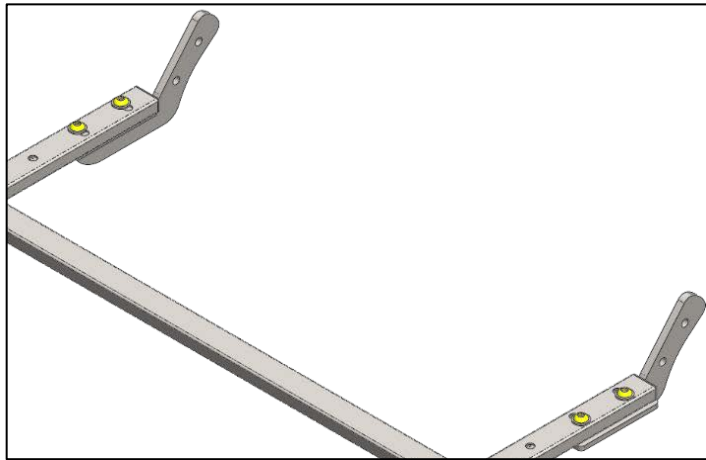

Fig.1

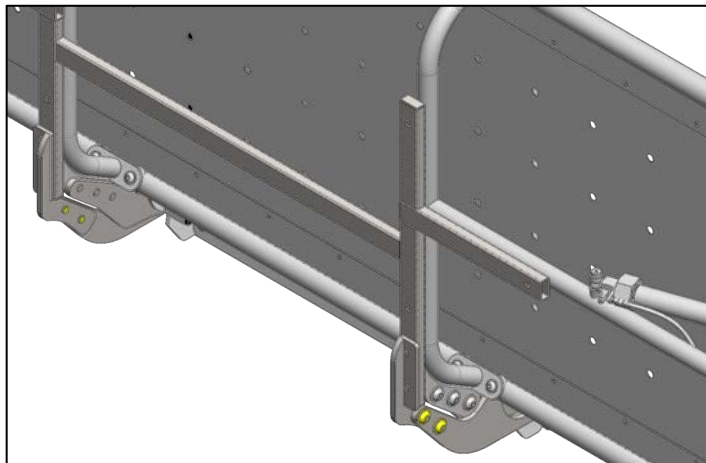

Fig.2

- Locate the plunger pin on the left-hand side of the shower stretcher (highlighted in Fig.3). With one hand on the drip tray frame, use your other hand to pull the head of the pin out, rotate it 90° and release it so that it stays in the unlocked position.
- Pull the drip tray frame down until it is roughly level with the floor. Then rotate the head of the plunger pin 90° and release.
- Move the frame up and down slightly until you hear the plunger pin 'click' into place.
- The product should look similar to the image shown in Fig.4.
- Tighten the bolts that were loosened on the frame earlier (shown in Fig.1).

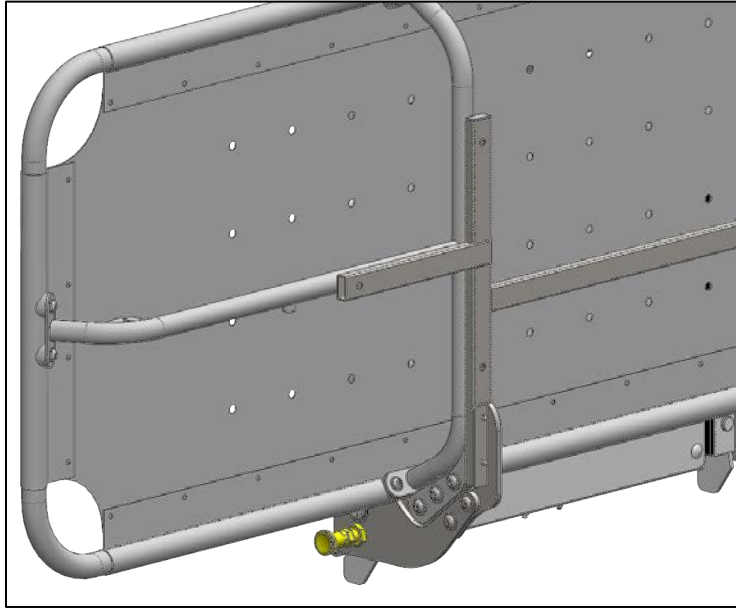

Fig.3

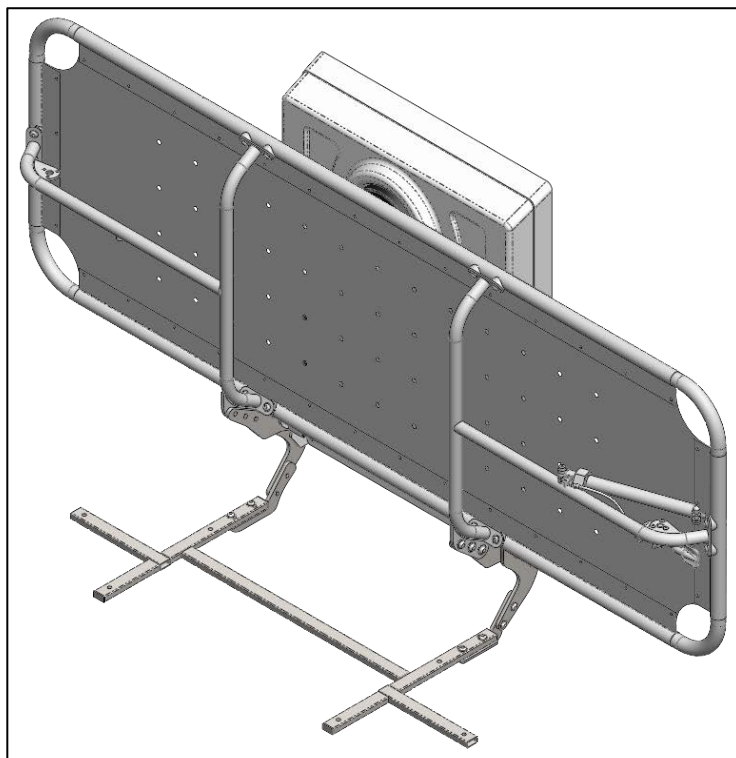

Fig.4

- Offer up the drip tray to the underside of the frame and line up the holes. Secure in place using the M8x25 bolts, washers and nuts (highlighted in Fig.5). Ensure the drainage hole is towards the back of the shower stretcher, closer to the wall.
- Insert the tray frame extensions into the frame and align the holes with the drip tray and the drip tray frame.
- Secure in place using the M8x20 bolts, washers and nuts. (highlighted in Figure 6).

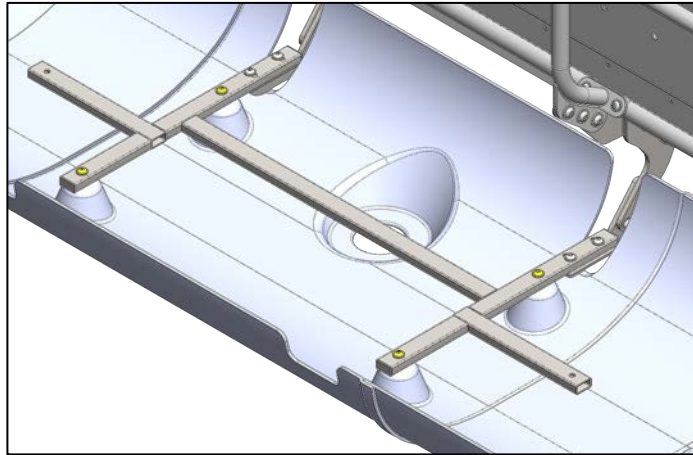

Fig.5

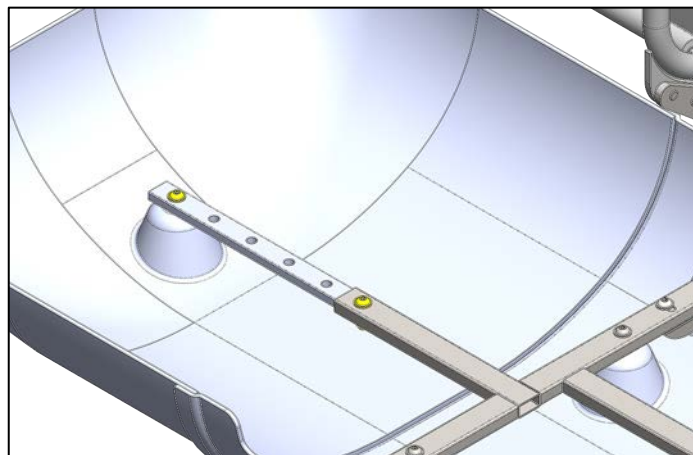

Fig.6

- Pull out the head of the plunger pin (shown in Fig.3). With the other hand, start to raise the drip tray.
- Once the tray has started to move, release the plunger pin and continue to lift the drip tray until the plunger pin 'clicks' into position. The product is now in the 'stowed' position (Fig.8).

3.3.1 ATTACHING THE HOSE

To attach the hose, press it onto the connector on the bottom of the drip tray and secure in place using the threaded attachment on the end of the hose (Fig.7).



Fig.7

4.0 USING THE DRIP TRAY

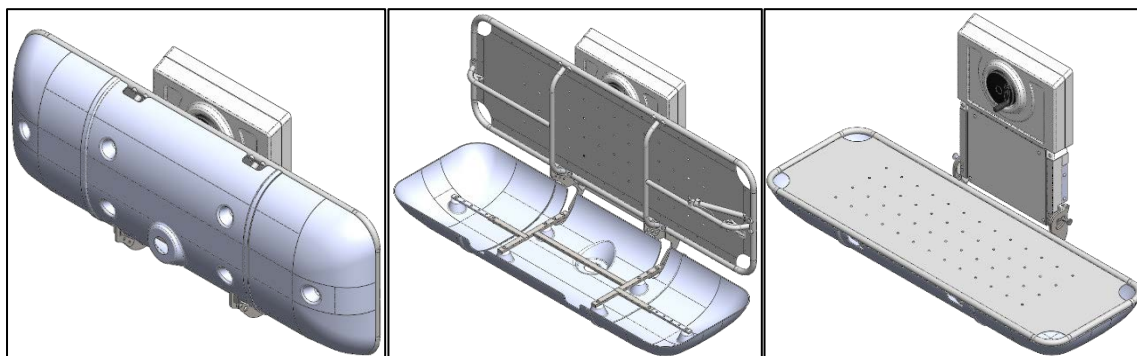

Fig.8

Fig.9

Fig.10

4.1 LOWERING THE DRIP TRAY (FIG.8 - FIG.9)

- Locate the plunger pin on the left-hand side of the back frame (highlighted in Fig.11). With one hand on the back of the drip tray, pull the head of the plunger out and rotate it 90° so that it stays in the locked position.
- Release the plunger pin and lower the drip tray down until it is roughly horizontal.
- Rotate the head of the plunger pin 90° and move the drip tray up and down until the plunger pin 'clicks' into place.

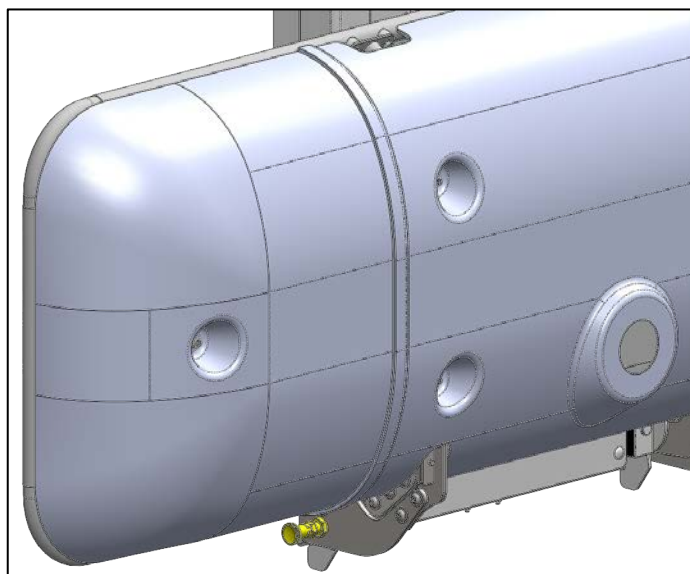

Fig.11

4.2 LOWERING THE STRETCHER (FIG.9-FIG.10)

- Pull the head of the plunger pin on the left-hand side of the back frame (Fig.11), rotate it 90° and release.
- Locate the plunger pin on the right-hand side of the back frame (highlighted in Fig.12).
- With one hand on the shower stretcher, pull the head of the plunger pin out and start to lower the stretcher.
- Release the plunger pin and continue to pull the stretcher down until you hear the plunger pin 'click' into place.
- Rotate the head of the left-hand plunger pin (Fig.11) 90° and move the drip tray up and down until the plunger pin 'clicks' into place.

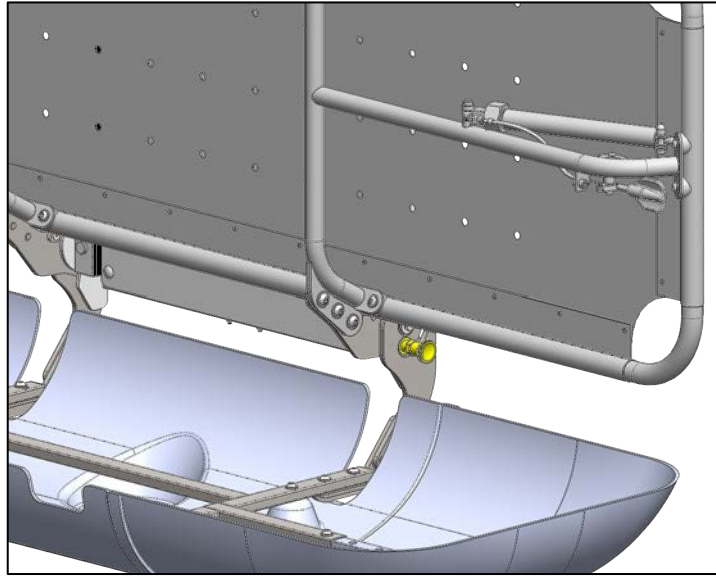

Fig.12

4.3 LOWERING THE STRETCHER AND DRIP TRAY TOGETHER (FIG.8 – FIG.10)

- To move the stretcher and drip tray down together, locate the plunger pin on the right-hand side of the back frame (highlighted in Fig.12).
- With one hand on the back of the drip tray, pull the head of the plunger pin out and start to lower the shower stretcher and the drip tray down. Once the stretcher has started to move, release the pin.
- Continue to lower the stretcher and drip tray until you hear the plunger pin 'click' into place.

4.4 RAISING THE SHOWER STRETCHER (FIG.10 – FIG 9)

- Pull the head of the plunger pin on the left-hand side of the back frame (Fig.11), rotate it 90° and release.
- Pull the head of the plunger pin on the right-hand side of the back frame (Fig.12) and with your other hand, start to lift the shower stretcher.
- Release the plunger pin and continue to lift the stretcher until you hear the pin 'click' into place.
- Rotate the head of the left-hand plunger pin 90° (Fig.11) and move the drip tray up and down until the plunger pin 'clicks' into place.

4.5 RAISING THE DRIP TRAY (FIG.9 – FIG.8)

- Pull the head of the plunger pin on the left-hand side of the back frame (Fig.11) and with your other hand, start to raise the drip tray.
- Release the plunger pin and continue to lift the drip tray until the pin 'clicks' back into place.

4.6 RAISING THE STRETCHER AND DRIP TRAY TOGETHER (FIG.10 – FIG.8)

- Pull the head of the plunger pin on the right-hand side of the back frame (Fig.12) and with your other hand, start to lift the shower stretcher.
- Release the plunger pin and continue to lift the stretcher and drip tray until you hear the pin 'click' into place.

5.0 ADJUSTMENTS

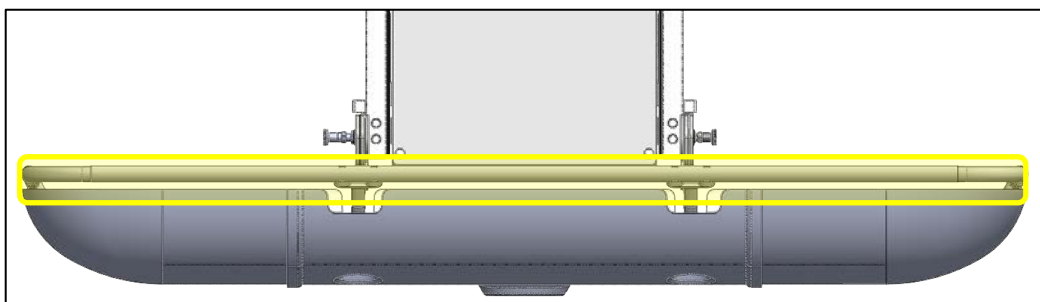

Fig.13

When the drip tray has been assembled and is in the position (shown in Fig.10), there should be an even, horizontal gap between the drip tray and the shower stretcher (as shown in Fig.13).

If this is not the case, then the attachment of the drip tray needs to be checked first followed by adjustment of the tray angle stops.

5.1 DRIP TRAY ATTACHMENT CHECK

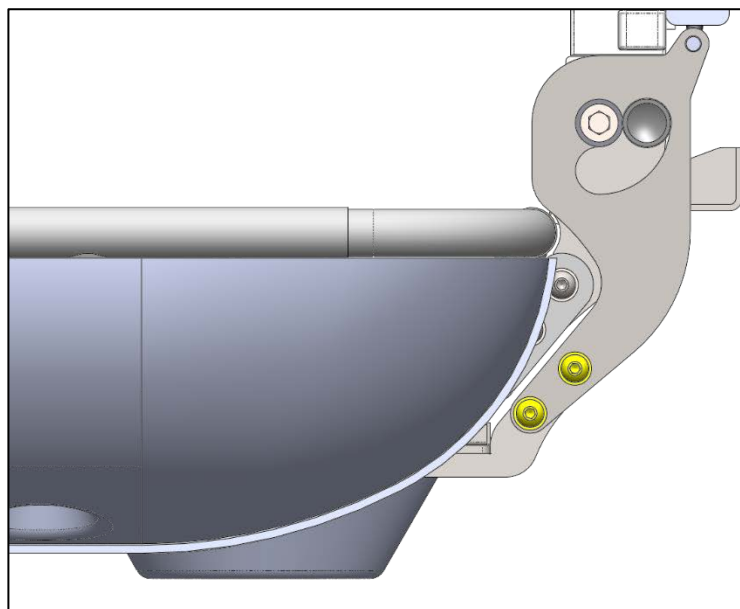

Fig.14

- Loosen the bolts highlighted in Fig.14 (these are the same as the bolts highlighted in Figure 2).
- Adjust the drip tray to the desired position and tighten the bolts to secure in position.

NOTE: The edges of the plates in the highlighted region should be flush but this may be different on your product.

5.2 ANGLE STOPS

5.2.1 ADJUSTABLE HEIGHT SHOWER STRETCHERS

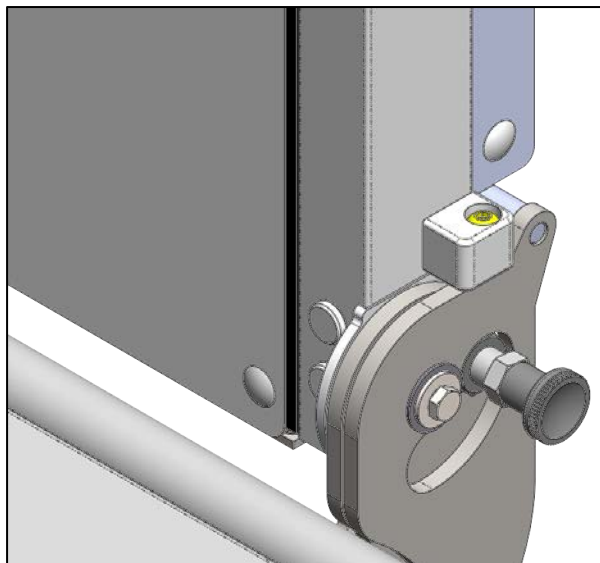

Fig.15

- Locate the angle adjustment screws on each side of the back frame (highlighted in Fig.15).
- Use a hex key to adjust the height of these screws which will alter the angle of the drip tray.
- Repeat for the other side.

5.2.2 FIXED HEIGHT SHOWER STRETCHER

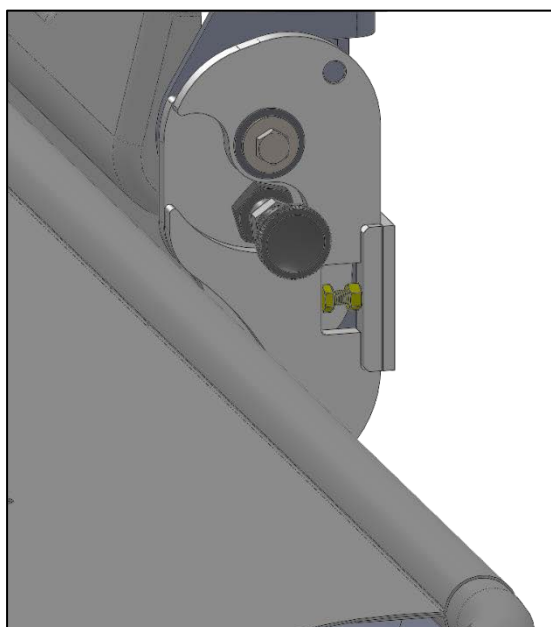



Fig.16

- Locate the angle adjustment bolts and locknuts on each side of the back frame (highlighted in Fig.16).
- Use a spanner to first loosen the nut. Then use a couple of spanners to set the bolt at the correct depth.
- Tighten the nut against the back plate.
- Repeat for the other side.

6.0 FOR YOUR SAFETY

	STOP!
	Please read these instructions CAREFULLY and THOROUGHLY.

- The patient should **NOT** be left unattended whilst in the product. Always ensure a responsible therapist or carer is in attendance.
- The carer should be familiar with the methods of use before transfer of a patient onto the product
- If fitted, ensure the guard rail is in the 'up' position once a patient is on the shower stretcher
- When storing the product vertically (up position), check to ensure that the locking plunger pin is fully engaged.
- Regular maintenance checks and cleaning are essential for the safe use of this equipment (see care and maintenance section).
- Always keep this product away from naked flames, cigarettes and sources of heat including open fireplaces, radiators and heaters.
- When not in use for periods of time, we recommend isolating the electrical supply.
- **DO NOT** fit parts or accessories of other manufacturers to this product unless authorized to do so in writing by Smirthwaite Ltd. Failure to follow these instructions will not only invalidate the guarantee but could make the product dangerous to use. Smirthwaite Ltd will not accept liability for any injury or damage incurred through such malpractices.
- In the unlikely event repair work is required it must **ONLY** be undertaken by Smirthwaite authorized personnel.
- If you believe the product or any fitted accessory to be faulty at any time, **DO NOT USE** – contact Smirthwaite by telephone on +44 (0)1626 835552.
- This product is CE marked. This certifies that it meets all relevant/applicable European directive

7.0 CARE AND MAINTENANCE

	IMPORTANT!
	CLEANING IS RECOMMENDED ON A REGULAR BASIS

- To clean the drip tray, use a damp soft cloth with mild soap.
- Rinse with clean cloth and water.
- DO NOT use solvents, abrasives, synthetic detergents and wax polishes.
- ALWAYS wipe dry after use.
- ALWAYS keep this product away from naked flames, cigarettes and sources of heat including open fireplaces, radiators and heaters.
- For further information please refer to MHRA or Local Authority cleaning guidelines.

8.0 DAILY CHECKS

	IMPORTANT!
	REGULAR MAINTENANCE CHECKS ARE REQUIRED

- Check for missing parts
- Check the shower stretcher for signs of damage or wear and tear
- Keep the shower stretcher parts clean
- Check that the guard rail can be stowed and locked into the vertical position (if fitted)
- Check that the head rest can be operated (if fitted).
- Check that the shower stretcher can be securely stored in the vertical position, and that the plunger locking pin engages.

9.0 SERVICE INTERVAL

This product should be serviced every year. Servicing must only be undertaken by a Smirthwaite service engineer, or by a Smirthwaite trained representative.

9.1 NOMINAL SERVICE LIFE

Your product has a nominal service life of 7 years, during which full post-sales support will be available with regard to spares and servicing.

Product service life has been determined based upon the design complexity of product, and the anticipated exposure to normal use.

Good practice dictates all Smirthwaite products have been designed and manufactured to high levels of safety and quality, and will meet requirements of normal use when maintained in line with our servicing recommendations.

	STOP!
	<p>If the product has been out of use for an extended period of time (6 months or more) it should always be serviced prior to being reissued.</p> <p>If the product has been subjected to ‘heavy’ or ‘constant’ use, the service should be reduced to half the recommended period. Constant and/or heavy use is considered to be:</p> <p>Daily use above 7 hours duration</p> <p>Weekly use above 5 days duration</p> <p>Monthly use above 10 months per year</p> <p>Use by a client who is at 90% to 100% of the maximum weight limit of the product. The maximum weight limit must NEVER be exceeded</p> <p>Use by a client who is extremely active, either voluntarily or involuntarily</p>

9.2 EXTENDING NOMINAL SERVICE LIFE

We are proud to produce products that have a reputation for quality and durability.

We believe our products have the potential to provide benefits to our clients beyond the nominal service life documented above.

We will continue to provide full support beyond the nominal service life provided the following conditions are met:

1. A full service schedule has been maintained.
2. A full service and inspection is undertaken at the end of the nominal service life period.
3. The product is subsequently serviced annually (or biannually if under ‘heavy/constant’ use conditions).
4. We reserve the right to limit support where parts/components are no longer available.

9.3 DOCUMENTATION/RECORDS

- It is the responsibility of the current equipment owner to ensure the 'Instructions for Use' manual and any further manuals for accessories fitted to the equipment are handed over to the new owner at the time of exchange/sale.
- It is the responsibility of the current equipment owner to ensure the service and inspection record form is kept up to date.

9.4 PRODUCT CONFIGURATION

- We will document and maintain a record of the original product configuration at the time of first sale.
- We will not be held responsible for any subsequent changes to this configuration unless authorized to do so in writing by Smirthwaite Ltd.
- It is the equipment owner's responsibility to maintain their own records of changes to the equipment configuration and to be able to provide such records to subsequent owners to maintain traceability.
- We recommend an inspection/service by a Smirthwaite Service Engineer (or Smirthwaite trained engineer) whenever a significant change is made to product configuration to ensure the product is safe to use. **If in any doubt, ALWAYS seek ADVICE.**



IMPORTANT REMINDER!

DO NOT fit parts or accessories of other manufacturers to this product unless authorized to do so in writing by Smirthwaite Ltd.

Any servicing or repairs required must be carried out by Smirthwaite Ltd (or a Smirthwaite trained engineer).

If you believe this product to be faulty – DO NOT USE – Contact Smirthwaite Ltd on T: +44 (0) 1626 835552

If in any doubt, ALWAYS seek ADVICE.

10.0 WARRANTY

Smirthwaite Ltd warrants the products detailed on your order to be free from defects in materials and workmanship for a period of 2 years from date of delivery. If a fault develops during the period, please call Customer Services by email or telephone 01626 835552 who will advise you on the best course of action. Possible action may be for us to arrange to send out one of our Service Engineers, or have the goods returned to us. Should a repair not be possible within the guarantee period we will replace the product for new or nearest equivalent product. In the unlikely event that we cannot repair or exchange we will refund in full.

This warranty is for the UK only. The warranty excludes faults due to accident, neglect, misuse, not following the Instructions and normal wear and tear. This warranty is in addition to your legal rights. Goods will only be collected from the original delivery address.

A charge may be made where the goods cannot be repaired under the terms of the warranty. You will be advised before this is made.

T: +44 (0)1626 835552

E: info@smirthwaite.co.uk

11.0 CONTINUOUS IMPROVEMENT

Smirthwaite Ltd is committed to continuous improvement to their product range. Should you have any suggestions or comments please send them to our product design department at: info@smirthwaite.co.uk

Smirthwaite Ltd reserves the right to change the specification or material without prior notice.

For catalogues, help and further information on our products please contact us at:

Smirthwaite Ltd
16 Wentworth Road Heathfield Devon.TQ12 6TL

T: +44 (0) 1626 835552

E: info@smirthwaite.co.uk

www.smirthwaite.co.uk

12.0 SERVICE INSPECTION

12.1 Product Information

Model Size:	
Date of Manufacture:	
Serial Number:	
Final Inspection:	

12.2 Service & inspection record form:

Date	Procedure	Service Personnel



Smirthwaite Ltd, 16 Wentworth Road, Heathfield, Newton Abbot, Devon, TQ12 6TL
T: +44 (0) 1626 835552 E: info@Smirthwaite.co.uk
www.Smirthwaite.co.uk